

# Titanium

BUYER'S GUIDE 2002

PATENT  
PENDING

Titanium  
Glendale RU

"The New  
Standard in  
Towability"

Titanium  
Glendale RU

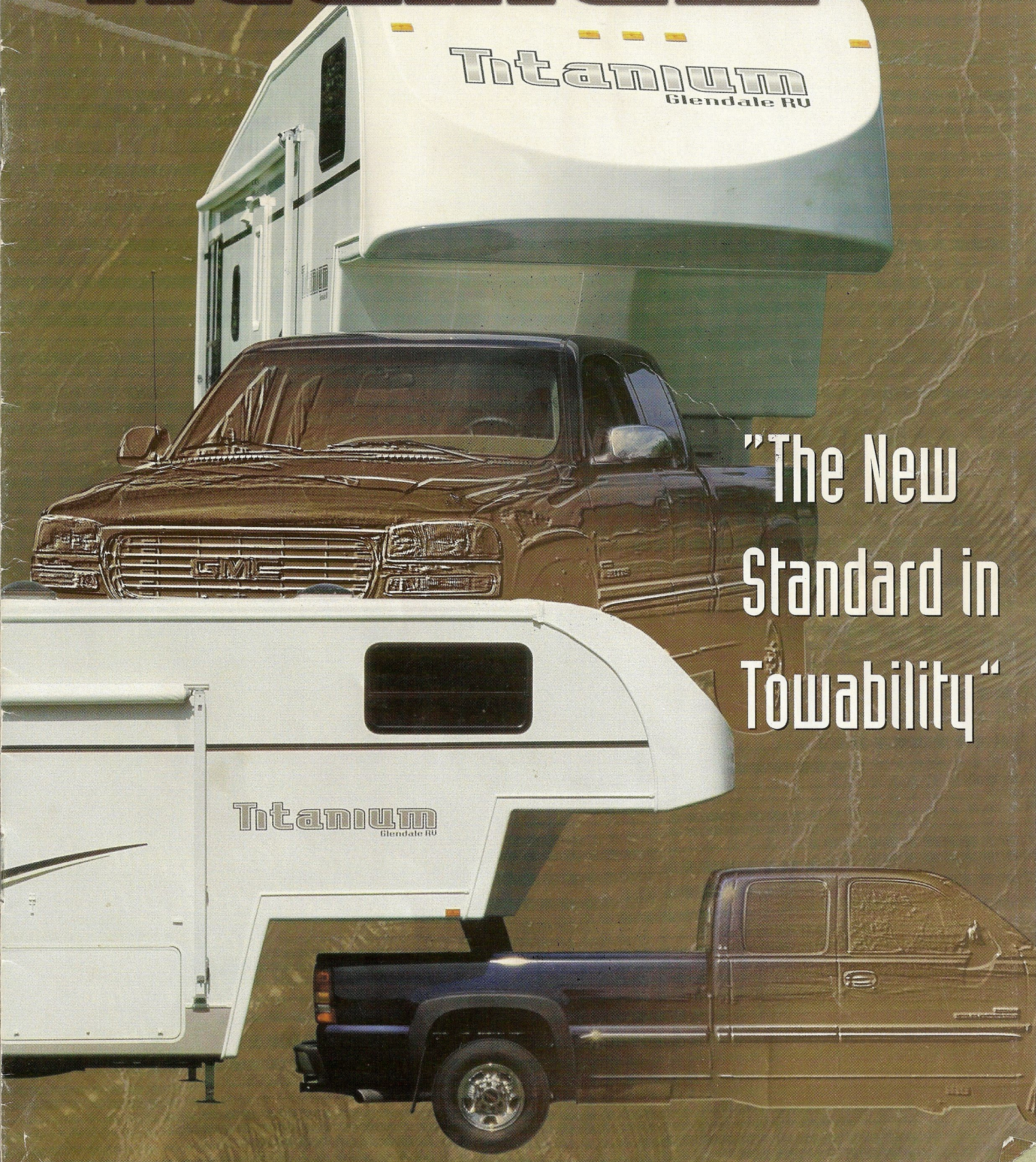

# 2002

# Titanium

The unique TITANIUM "Cab Over" design permits more of the RV interior layout to be positioned forward of the truck rear axle. The result of this forward shift of the floor plan allows for the combined length of the fifth wheel and truck to be considerably shorter.

The owner experiences all of the comparable interior living space, comfort, and features of a longer fifth wheel while enjoying the handling benefits of a much shorter fifth wheel.

Streamlined TITANIUM front cap aerodynamics reduce RV Wind Drag, thereby providing outstanding road handling and stability.

The advanced TITANIUM technology design contributes to significant FUEL savings when compared to towing conventional styled fifth wheel designs of equal length and weight.

LITE WEIGHT composite materials are used during production which provide significantly reduced overall weight. The reduction in weight and the ability to have a shorter RV without sacrificing comfort, provides more flexibility and more freedom of tow vehicle choice.



32E37

*Product innovation has been the hallmark of Glendale's reputation, and this has never been more evident than with the TITANIUM design.*



*Be sure to test tow this exciting fifth wheel today...*

*Feel just how easy towing can be.*



24E29

*Only 6500 lbs. dry weight — including hitch weight!*



**The NEW 2002 29E34RL**  
with the Garden Blue Decor Scheme.



**All TITANIUM models feature an amazing 6'4" floor to ceiling clearance with the vaulted cathedral ceiling in the bedroom area.**

**TITANIUM fifth wheels offer an outstanding line up of standard equipment, design enhancements, and easy towability conveniences that simply propel TITANIUM to a new level of ownership pride and confidence. Compare the advantages today...**

## OPTIONAL FEATURE PACKAGES

Available on Selected Models

### Interior Package

Fluorescent ceiling lights, day/night shades throughout in place of venetian blinds, oak galley area flooring in place of vinyl flooring.

### Entertainment Package

27" Panasonic TV and stereo VCR.

### Comfort Package

15,000 BTU air conditioner upgrade with digital programmable wall thermostat, powered roof vent in bedroom, central vacuum, living area paddle fan.



**The 29E34RL kitchen layout with added counter storage cavities.**

# Titanium

GLENDALE RV



**The NEW 2002 32E37DS**  
with the Moss Green Decor Scheme.

Your local TITANIUM dealer:

Kitsmiller RV, Inc.  
1211 N. Cedar  
Mason, Michigan 48854  
(517) 694-7500

Contact your local dealer  
for detailed product  
specifications and  
available floorplans.

Be sure to test tow this  
exciting fifth wheel today.

Feel just how easy towing  
can be.

## Glendale Recreational Vehicles

145 Queen Street  
Strathroy, Ontario  
Canada N7G 3J6

Photographs and illustrations are for demonstration purposes only.  
Please refer to model specification data for detailed product  
information. All information may change without notice or obligation.  
06/2001



Visit our web site at: [www.titaniumrv.com](http://www.titaniumrv.com)

# 2002 Titanium Sidewall Profiles



24E29



29E34



28E33B



29E34RL



28E33



32E37

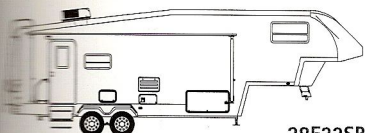

28E33SB

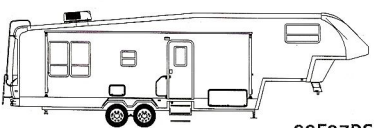

32E37DS

## 2002 Titanium Specifications

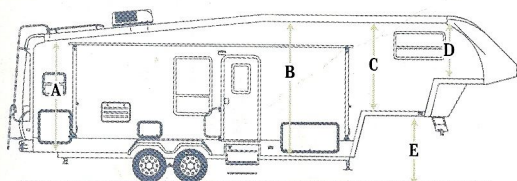

	A. Rear of Living Area	B. Front of Living Area	C. Rear of Bedroom Area	D. Bedroom/ Ceiling Area	E. Pin Box Area Clearance Dimensions
<b>24E29</b>	81"	81"	77"	49"	58"
<b>28E33B</b>	81"	81"	77"	49"	58"
<b>28E33</b>	81"	81"	77"	49"	58"
<b>28E33SB</b>	81"	81"	77"	49"	58"
<b>29E34</b>	81"	81"	77"	49"	58"
<b>29E34RL</b>	81"	81"	77"	49"	58"
<b>32E37</b>	81"	81"	77"	49"	58"
<b>32E37DS</b>	81"	81"	77"	49"	58"

## Getting Hitched

All of our Titanium models are designed to provide exceptionally high clearance between the underside of the Titanium pin box area, and the top of the sidewall surfaces of pickup truck payload boxes. Generous clearance dimensions assist in providing a level towing character between the RV and the pickup, and provide extra clearance to help prevent any possible contact between the RV and the truck box while traveling on grade. This clearance extends to include most 4 x 4 truck heights.

## A word about this Guide

The units described in this guide incorporate components produced by Glendale Recreational Vehicles and related companies and suppliers. During manufacturing, different components than initially scheduled may be used. All illustrations and specifications contained in this book are based on the latest product information available at the time of publication approval. However, because we continually upgrade and improve our product, the right is reserved to make changes at any time, without notice, in colours, materials, equipment, specifications and models. We also reserve the right to add or discontinue models without prior notice. Some equipment shown or described throughout this guide may only be available at extra cost and/or may only be available prior to production. Some options may not be available when your unit is built. Photos and drawings are representative of the products and may differ from actual production models. HOLDING TANK CAPACITIES = U.S. Gallons.

# Structural Highlights:

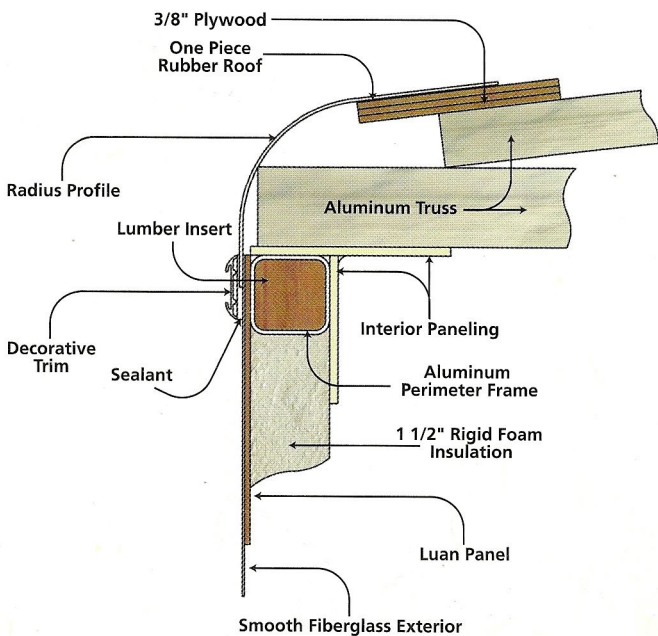
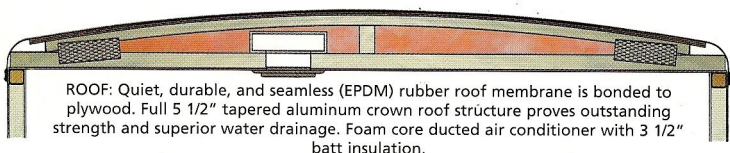

## 2002 Insulation Values

Ceiling	R-12
Sidewall	R-9
Floor	R-16

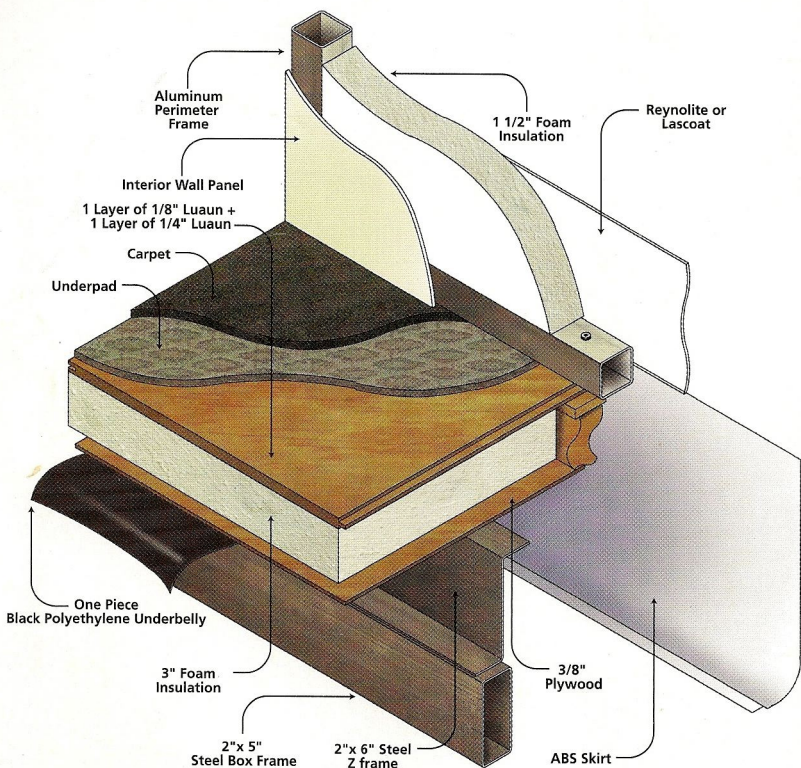

## FIFTH WHEEL 24E29 2002 MODEL YEAR

By Glendale RV  
Website: [www.titaniumrv.com](http://www.titaniumrv.com)



All specifications subject to change without notice or obligation 06/15/2001.

OVERALL LENGTH	LENGTH - PIN TO BUMPER	G.V.W.R.	PIN WEIGHT	DRY WEIGHT	OVERALL HEIGHT	MAIN BODY WIDTH
29' - 5 1/4"	24' - 3"	8,375 lb.	1,300 lb.	6,525 lb.	12' - 4"	96"

### CONSTRUCTION

**SIDEWALLS:** Vacuum bonded ultra smooth fiberglass siding. Perimeter welded Lightweight aluminum sidewall framing and 1 1/2" rigid foam insulation.

**ROOF:** Seamless polymer roof membrane is bonded to 3/8" plywood decking. Full 5 1/2" tapered aluminum truss framing. Thick fiberglass batt insulation. Cathedral ceilings in bedroom.

**FLOOR:** Composite laminated floor structure includes 3" foam insulation panel bonded between plywood panels and perimeter framing. Darco polyethylene moisture barrier between chassis and floor. Poly sheet panels are used to enclose the chassis underbelly. Seam guard under vinyl floor coverings.

**CHASSIS:** 11" combination Z channel/steel tube frame construction, twin 5,000 lb. 3" heavy duty axle assemblies, axle shocks at all wheels, Goodyear ST225/75P15 "C" radial tires, venting wheel rims, 12" x 2" electric brakes, underslung spare tire and rim, snap release pins on powered front landing gear, 2 stabilizer scissor jacks, 72 degree adjustable pin box.

**SLIDE OUT SPECIFICATIONS:** Low maintenance powerful rack and gear direct drive motor system, flush floor design, gear box release lever included for system manual override.

**INTERIOR CABINET DOORS:** Combination of raised panel oak cabinet doors. "Easy-Glide" metal roller system on all drawers.

**WINDOWS:** Radius corner bronze tinted solar reflective glass.

**ENTRANCE DOOR:** 30" wide radius corner combination entrance door with screen and deadbolt lock, easy fold-away 24" triple rise entry steps, fold away assist handle on entry door, porch light.

### APPLIANCES

**REFRIGERATOR:** Norcold 8 cu. ft. double door, 2 way gas/110V.

**RANGE:** Wedgewood H/O 21", 3 burner, piezo ignitor.

**FURNACE:** Atwood 2 stage Excalibur furnace 34,000 BTU ducted in floor heat system.

**MICROWAVE OVEN:** Dometic 22" 1.2 cu. ft. with turntable and built in range hood, light and exhaust fan.

**AIR CONDITIONER:** Dometic Briskair 13,500 BTU thermal insulated ducted in ceiling cool air system.

### ENTERTAINMENT

**STEREO:** Sanyo MCD-S500 AM/FM stereo CD with remote and clock.

**TV ANTENNA:** Winegard RV antenna with booster.

**TV HOOKUP:** Coax cable hookup in bedroom and living area.

**TELEPHONE JACK:** Standard equipment.

**SATELLITE HOOKUP:** Pre-wired for quick dish connection to the RV.

**EXTERIOR SOUND CENTRE:** 2 auxiliary speakers.

### AWNING

**A&E 19' AWNING:** Aloe/White awning features patented rugged steel roller tube and heavy duty torsion spring. 8' extension.

### PLUMBING & ELECTRICAL

High profile Aqua magic foot pedal flush toilet, single lever faucet in kitchen and bath vanity, in-line water filter, water heater by-pass kit, deep single sink in galley.

**WATER HEATER:** Atwood fast recovery 10 gallon gas/electric (Direct Spark Ignition).

**HOLDING TANKS:** Holding tanks are enclosed, insulated and heated. Garden style drain tap on fresh water tank, sewage tank flush system.

### HOLDING TANK CAPACITIES:

Fresh: 48 gallon Grey: 41 gallon Sewage: 41 gallon

### ELECTRICAL CONVERTOR: Magnatek 7345

solid state circuitry, whisper quiet operation.

### OTHER STANDARD FEATURES

Fiberglass front and back end caps, roof rack and ladder, oak edge counter tops, daveno, exterior rinse shower, axle shock kit, wire rack wardrobe shelf, venetian blinds, 2 x 30 lb. propane bottles with auto changeover reg. systems monitor panel, color co-ordinated ABS lower sidewall skirting, huge under bed storage cavity, 60" x 74" queen bed.

### OPTIONAL EQUIPMENT

Twin beds, sofa bed in place of daveno, thermopane windows, storm windows, day/night shades in place of venetian blinds, washer/dryer hookup, polished aluminum wheel package, dual exterior security lights, blanket box style sofa table, dual powered front landing gear, porcelain toilet, Reynolite smooth aluminum exterior, folding dinette chairs, straight dinette chairs, straight table with 2 chairs.

### OPTIONAL FEATURE PACKAGE UPGRADES

**INTERIOR PACKAGE:** Fluorescent ceiling lights, day/night shades throughout in place of venetian blinds, oak galley area flooring in place of vinyl flooring.

**ENTERTAINMENT PACKAGE:** 27" Panasonic TV and stereo VCR.

**COMFORT PACKAGE:** 15,000 BTU air conditioner upgrade with digital programmable wall mount thermostat, powered roof vent in bedroom, central vacuum.

*Front cap design provides a natural air foil that appears to mold itself over the cab area of the pick-up.*

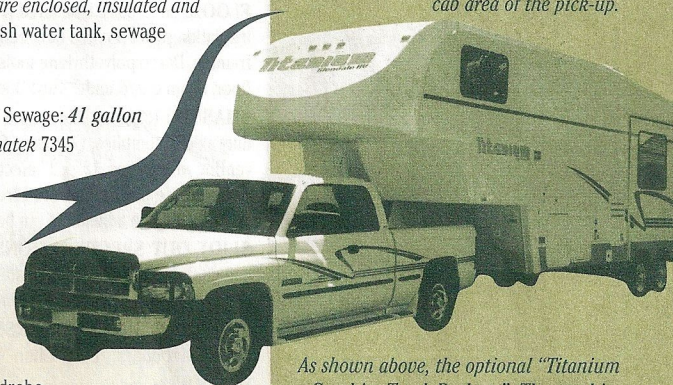

*As shown above, the optional "Titanium Graphics Truck Package". The graphics supplied will look similar to those on the sidewall of the Titanium fifth wheel.*

## Easy Towability

*The use of lightweight composite materials significantly reduce the overall weight and provides more freedom of truck choices for potential owners.*

# Titanium

## FIFTH WHEEL 28E33B 2002 MODEL YEAR

By Glendale RV  
Website: [www.titaniumrv.com](http://www.titaniumrv.com)



The 28E33B features bunk bed area which converts into a convenient storage cavity when traveling.



Optional aluminium rims.

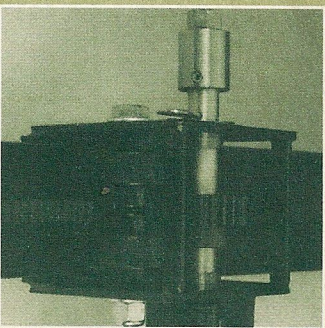

Our high quality, low friction, rack and gear electric slide out system features fast, super quiet operation. There are only a few working parts, making maintenance a breeze.

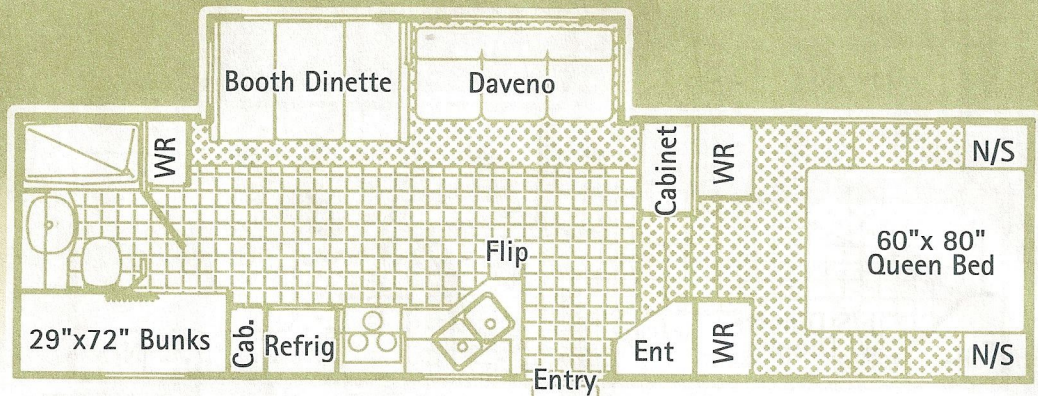

All specifications subject to change without notice or obligation 06/15/2001.

OVERALL LENGTH	LENGTH - PIN TO BUMPER	G.V.W.R.	PIN WEIGHT	DRY WEIGHT	OVERALL HEIGHT	MAIN BODY WIDTH
33' - 7"	28' - 5"	9,652 lb.	1,562 lb.	7,590 lb.	12' - 3"	96"

### CONSTRUCTION

**SIDEWALLS:** Vacuum bonded ultra smooth fiberglass siding. 1 1/2" rigid foam insulation.

**ROOF:** Seamless polymer roof membrane is bonded to 3/8" plywood decking. Full 5 1/2" tapered aluminum truss framing. Thick fiberglass batt insulation. Cathedral ceilings in bedroom.

**FLOOR:** Composite laminated floor structure includes 3" foam insulation panel bonded between plywood panels and perimeter framing. Darco polyethylene moisture barrier between chassis and floor. Seam guard under vinyl floor coverings.

**CHASSIS:** 10" steel tube frame construction, twin 5,000 lb. 3" heavy duty axle assemblies, Goodyear ST225/75R15" "C" radial tires, 6 bolt venting wheel rims, 12" x 2" electric brakes, spare tire/rim/carrier, snap release pins on powered front landing gear, 2 stabilizer scissor jacks, 72 degree adjustable pin box.

**SLIDE OUT SPECIFICATIONS:** Low maintenance powerful rack and gear direct drive motor system, flush floor design, gear box release lever included for system manual override.

**INTERIOR CABINET DOORS:** Combination of flat panel and raised oak cabinet doors, "Easy-Glide" metal roller system on all drawers.

**WINDOWS:** Radius corner, bronze tinted, solar reflective safety glass.

**ENTRANCE DOOR:** 30" wide radius corner combination entrance door with screen and deadbolt lock, easy fold-away 24" triple rise entry steps, fold away assist handle on entry door, porch light.

### APPLIANCES

**REFRIGERATOR:** Norcold 8 cu. ft. double door, 2 way gas/110V.

**RANGE:** Wedgewood H/O 21", 3 burner, piezo ignitor.

**FURNACE:** Hydroflame furnace 35,000 BTU ducted in floor heat system.

**MICROWAVE OVEN:** Dometic 22" 1.2 cu. ft. with turntable and built in range hood, light and exhaust fan.

**AIR CONDITIONING:** 13,500 BTU ducted in ceiling air conditioning system.

### ENTERTAINMENT

**STEREO:** Sanyo MCD-S500 AM/FM stereo CD with remote and clock.

**TV ANTENNA:** Winegard RV antenna with booster.

**TV HOOKUP:** Coax cable hookup in bedroom and living area.

### AWNING

**A&E 20' AWNING:** Aloe/White awning features patented rugged steel roller tube and heavy duty torsion spring. 8' extension.

### PLUMBING & ELECTRICAL

High profile Aqua magic toilet, ABS tub surround, folding shower door, single lever faucet in kitchen and bath vanity, water heater by-pass kit.

**WATER HEATER:** Atwood fast recovery 10 gallon gas/electric (Direct Spark Ignition).

**HOLDING TANKS:** Garden style drain tap on fresh water tank.

### HOLDING TANK CAPACITIES:

Fresh: 48 gallon Grey: 41 gallon Sewage: 49 gallon

**ELECTRICAL CONVERTOR:** Magnatek 6345 series linear circuitry.

### OTHER STANDARD FEATURES

Fiberglass front and back end caps, daveno, exterior rinse shower venetian blinds, 2 x 30 lb. propane bottles with auto changeover reg. systems monitor panel, color co-ordinated ABS lower sidewall skirting, huge under bed storage cavity.

### OPTIONAL EQUIPMENT

Twin beds, oak free standing dinette in place of booth style dinette, sofa bed in place of daveno, thermopane windows, storm windows, day/night shades in place of venetian blinds, enclosed insulated, and heated holding tanks, satellite hookup, axle shock kit, polished aluminum wheel package, porcelain toilet, dual exterior security lights, dual front landing gear.

### OPTIONAL FEATURE PACKAGE UPGRADES

**ENTERTAINMENT PACKAGE:** 27" Panasonic TV and stereo VCR.

Be sure to test tow this exciting  
fifth wheel today,  
"feel just how easy towing can be"

Go RVing  
Life's A Trip™

Titanium  
Glendale RV



# Titanium

FIFTH WHEEL

28E33

2002

MODEL YEAR

By Glendale RV

Website: [www.titaniumrv.com](http://www.titaniumrv.com)

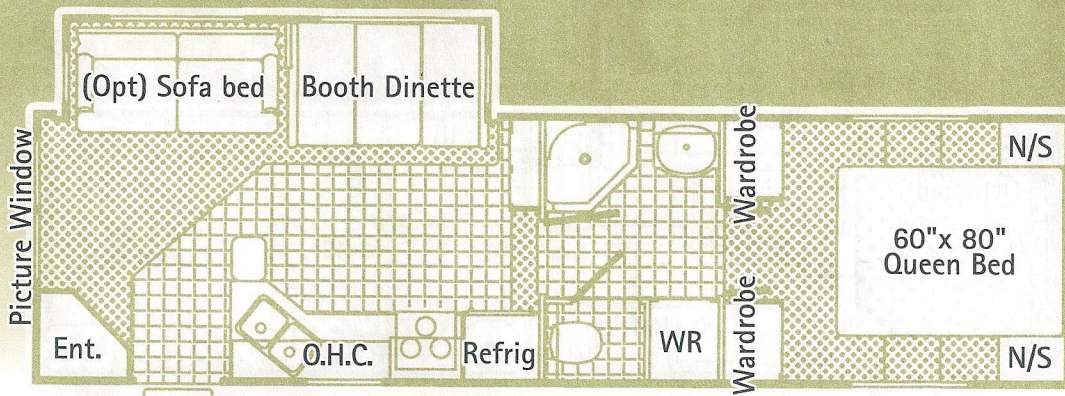

All specifications subject to change without notice or obligation 06/15/2001.

OVERALL LENGTH	LENGTH - PIN TO BUMPER	G.V.W.R.	PIN WEIGHT	DRY WEIGHT	OVERALL HEIGHT	MAIN BODY WIDTH
33' - 5 <sup>3</sup> / <sub>4</sub> "	28' - 4"	10,170 lb.	1,604 lb.	8,037 lb.	12' - 4"	96"

## CONSTRUCTION

**SIDEWALLS:** Vacuum bonded ultra smooth fiberglass siding, perimeter welded Lightweight aluminum sidewall framing and 1 1/2" rigid foam insulation.

**ROOF:** Seamless polymer roof membrane is bonded to 3/8" plywood decking. Full 5 1/2" tapered aluminum truss framing. Thick fiberglass batt insulation. Cathedral ceilings in bedroom.

**FLOOR:** Composite laminated floor structure includes 3" foam insulation panel bonded between plywood panels and perimeter framing. Darco polyethylene moisture barrier between chassis and floor. Poly sheet panels are used to enclose the chassis underbelly. Seam guard under vinyl floor coverings.

**CHASSIS:** 11" combination Z channel/steel tube frame construction, twin 5,000 lb. 3" heavy duty axle assemblies, axle shocks at all wheels, Goodyear ST225/75P15" "C" radial tires, venting wheel rims, 12" x 2" electric brakes, underslung spare tire and rim, snap release pins on powered front landing gear, 2 stabilizer scissor jacks, 72 degree adjustable pin box.

**SLIDE OUT SPECIFICATIONS:** Low maintenance powerful rack and gear direct drive motor system, flush floor design, gear box release lever included for system manual override.

**INTERIOR CABINET DOORS:** Combination of raised panel oak cabinet doors. "Easy-Glide" metal roller system on all drawers.

**WINDOWS:** Radius corner bronze tinted solar reflective glass.

**ENTRANCE DOOR:** 30" wide radius corner combination entrance door with screen and deadbolt lock, easy fold-away 24" triple rise entry steps, fold away assist handle on entry door, porch light.

## APPLIANCES

**REFRIGERATOR:** Norcold 8 cu. ft. double door, 2 way gas/110V.

**RANGE:** Wedgewood H/O 21", 3 burner, piezo ignitor.

**FURNACE:** Atwood 2 stage Excalibur furnace 34,000 BTU ducted in floor heat system.

**MICROWAVE OVEN:** Dometic 22" 1.2 cu. ft. with turntable and built in range hood, light and exhaust fan.

**AIR CONDITIONER:** Dometic Briskair 13,500 BTU thermal insulated ducted in ceiling cool air system.

## ENTERTAINMENT

**STEREO:** Sanyo MCD-S500 AM/FM stereo CD with remote and clock.

**TV ANTENNA:** Winegard RV antenna with booster.

**TV HOOKUP:** Coax cable hookup in bedroom and living area.

**TELEPHONE JACK:** Standard equipment.

**SATELLITE HOOKUP:** Pre-wired for quick dish connection to the RV.

**EXTERIOR SOUND CENTRE:** 2 auxiliary speakers.

## AWNING

**A&E 19' AWNING:** Aloe/White awning features patented rugged steel roller tube and heavy duty torsion spring. 8' extension.

## PLUMBING & ELECTRICAL

High profile Aqua magic foot pedal flush toilet, single lever faucet in kitchen and bath vanity, in-line water filter, water heater by-pass kit, deep single sink in galley.

**WATER HEATER:** Atwood fast recovery 10 gallon gas/electric (Direct Spark Ignition).

**HOLDING TANKS:** Holding tanks are enclosed, insulated and heated. Garden style drain tap on fresh water tank, sewage tank flush system.

### HOLDING TANK CAPACITIES:

Fresh: 48 gallon Grey: 41 gallon Sewage: 41 gallon

**ELECTRICAL CONVERTOR:** Magnatek T345 solid state circuitry, whisper quiet operation.

## OTHER STANDARD FEATURES

Fiberglass front and back end caps, roof rack and ladder, oak edge counter tops, daveno, exterior rinse shower, axle shock kit, wire rack wardrobe shelf, venetian blinds, 2 x 30 lb. propane bottles with auto changeover reg. systems monitor panel, color co-ordinated ABS lower sidewall skirting, huge under bed storage cavity, 60" x 74" queen bed.

## OPTIONAL EQUIPMENT

Twin beds, sofa bed in place of daveno, thermopane windows, storm windows, day / night shades in place of venetian blinds, washer/dryer hookup, polished aluminum wheel package, dual exterior security lights, blanket box style sofa table, dual powered front landing gear, porcelain toilet, Reynolite smooth aluminum exterior, folding dinette chairs, straight dinette chairs, straight table with 2 chairs.

## OPTIONAL FEATURE PACKAGE UPGRADES

**INTERIOR PACKAGE:** Fluorescent ceiling lights, day/night shades throughout in place of venetian blinds, oak galley area flooring in place of vinyl flooring.

**ENTERTAINMENT PACKAGE:** 27" Panasonic TV and stereo VCR.

**COMFORT PACKAGE:** 15,000 BTU air conditioner upgrade with digital programmable wall mount thermostat, powered roof vent in bedroom, central vacuum, living area paddle fan.

*Be sure to test tow this exciting  
fifth wheel today,  
"feel just how easy towing can be"*

*Superior sidewall strength and excellent thermal values are achieved by utilizing rigid 1-1/2" thermal foam black insulation.*

*The "Full Lamination" vacuum bonding process ensures "Beam" like structural integrity.*

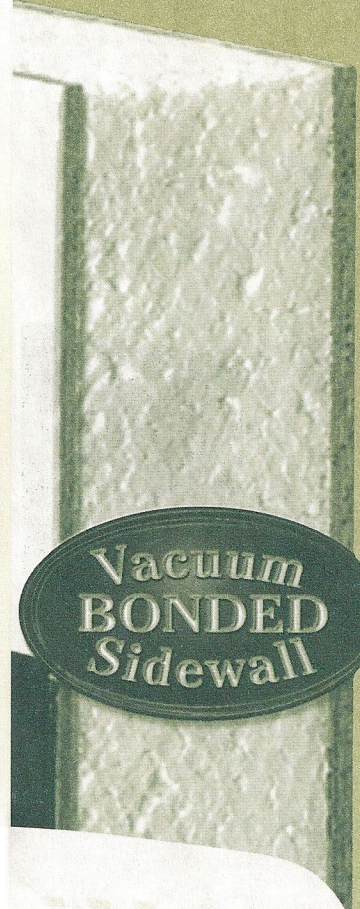

Titanium  
Glendale RV

# Titanium

## FIFTH WHEEL 28E33SB

2002  
MODEL YEAR

By Glendale RV  
Website: www.titaniumrv.com

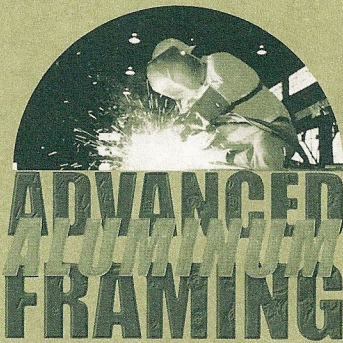

Titanium fifth wheels are constructed using electrically welded 1-1/2" tubular aluminum framing. The aluminum framing is light weight and provides outstanding long term durability.

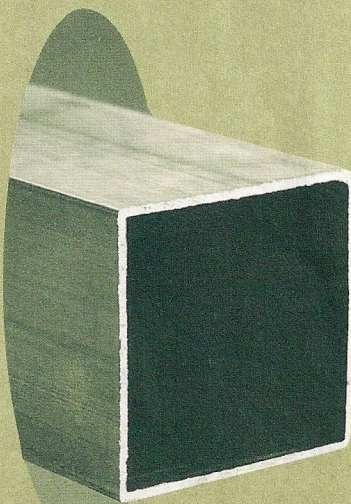

The aluminium framing is used for our engineered roof truss system and for perimeter framing.

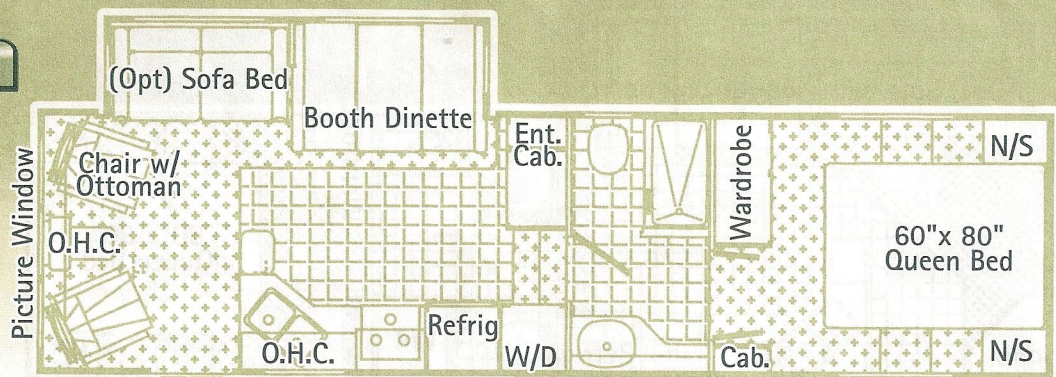

All specifications subject to change without notice or obligation 06/15/2001.

OVERALL LENGTH	LENGTH - PIN TO BUMPER	G.V.W.R.	PIN WEIGHT	DRY WEIGHT	OVERALL HEIGHT	MAIN BODY WIDTH
33' - 5 <sup>3</sup> / <sub>4</sub> "	28' - 4"	10,170 lb.	1,604 lb.	8,250 lb.	12' - 4"	96"

### CONSTRUCTION

**SIDEWALLS:** Vacuum bonded ultra smooth fiberglass siding. Perimeter welded lightweight aluminum sidewall framing and 1 1/2" rigid foam insulation.

**ROOF:** Seamless rubber roof membrane is bonded to 3/8" plywood decking. Full 5 1/2" tapered aluminum truss framing. Thick fiberglass batt insulation.

**FLOOR:** Composite laminated floor structure includes 3" foam insulation panel bonded between plywood panels and perimeter framing. Darco polyethylene moisture barrier between chassis and floor. Poly sheet panels are used to enclose the chassis underbelly. Seam guard under vinyl floor coverings.

**CHASSIS:** 11" combination Z channel/steel tube frame construction, twin 5,000 lb. 3" heavy duty axle assemblies, axle shocks at all wheels, Goodyear LT215/85R16" "E" radial tires, 6 bolt venting wheel rims, 12"x 2" electric brakes, underslung spare tire and rim, snap release pins on powered front landing gear, 2 stabilizer scissor jacks, 72 degree adjustable pin box.

**SLIDE OUT SPECIFICATIONS:** Low maintenance powerful rack and gear direct drive motor system, flush floor design, gear box release lever included for system manual override.

**INTERIOR CABINET DOORS:** Raised panel oak cabinet doors. "Easy-Glide" metal roller system on all drawers.

**WINDOWS:** Radius corner, bronze tinted, solar reflective safety glass

**ENTRANCE DOOR:** 30" wide radius corner combination entrance door with screen and deadbolt lock, easy fold-away 24" triple rise entry steps, fold away assist handle on entry door, porch light.

### APPLIANCES

**REFRIGERATOR:** Norcold 8 cu. ft. double door, 2 way gas/100V.

**RANGE:** Wedgewood H/O 21", 3 burner, piezo ignitor.

**FURNACE:** Atwood 2 stage Excalibur furnace 34,000 BTU ducted in floor heat system.

**MICROWAVE OVEN:** Dometic 22" 1.2 cu.. ft. with turntable and built in range hood, light and exhaust fan.

**AIR CONDITIONER:** Dometic Briskair 13,500 BTU thermal insulated ducted in ceiling cool air system.

### ENTERTAINMENT

**STEREO:** Sanyo MCD-S500 AM/FM stereo CD with remote and clock.

**TV ANTENNA:** Winegard RV antenna with booster.

**TV HOOKUP:** Coax cable hookup in bedroom and living area.

**TELEPHONE JACK:** Standard equipment.

**SATELLITE HOOKUP:** Pre-wired for quick dish connection to the RV.

**EXTERIOR SOUND CENTRE:** 2 auxiliary speakers.

### AWNING

**A&E 19'AWNING:** Aloe/White awning features patented rugged steel roller tube and heavy duty torsion spring. 8' extension.

### PLUMBING & ELECTRICAL

High profile Aqua magic foot pedal flush toilet, shower/ bath tub, single lever faucet in kitchen and bath vanity, in-line water filter, water heater by-pass kit.

**WATER HEATER:** Atwood fast recovery 10 gallon gas/electric (Direct Spark Ignition).

**HOLDING TANKS:** Holding tanks are enclosed, insulated and heated. Garden style drain tap on fresh water tank, sewage tank flush system.

### HOLDING TANK CAPACITIES:

Fresh: 48 gallon Grey: 49 gallon Sewage: 49 gallon

**ELECTRICAL CONVERTOR:** Magnatek 7345 solid state circuitry, whisper quiet operation.

### OTHER STANDARD FEATURES

Fiberglass front and back end caps, roof rack and ladder, oak edge counter tops, daveno, exterior rinse shower, wire rack wardrobe shelf, venetian blinds, 2 x 30 lb. propane bottles with auto changeover reg. systems monitor panel, huge under bed storage cavity, french doors in bedroom area, colour coordinated lower sidewall skirting.

### OPTIONAL EQUIPMENT

Twin beds, oak free standing dinette in place of booth style dinette, sofa bed in place of daveno, electric fireplace insert, thermopane windows, generator ready connections, storm windows, Generac Impact 36LPG generator, day/night shades in place of venetian blinds, washer/dryer hookup, polished aluminum wheel package dual exterior security lights, blanket box style sofa table, dual front landing gear, porcelain toilet.

### OPTIONAL FEATURE PACKAGE UPGRADES

**INTERIOR PACKAGE:** Fluorescent ceiling lights, day/night shades throughout in place of venetian blinds, oak galley area flooring in place of vinyl flooring.

**ENTERTAINMENT PACKAGE:** 27" Panasonic TV and stereo VCR.

**COMFORT PACKAGE:** 15,000 BTU air conditioner upgrade with digital programmable wall mount thermostat, powered roof vent in bedroom, central vacuum, living area paddle fan.

Be sure to test tow this exciting  
fifth wheel today,  
"feel just how easy towing can be"

Go RVing  
Life's A Trip™

Titanium  
Glendale RV

# Titanium

## FIFTH WHEEL 29E34 2002 MODEL YEAR

By Glendale RV  
Website: [www.titaniumrv.com](http://www.titaniumrv.com)

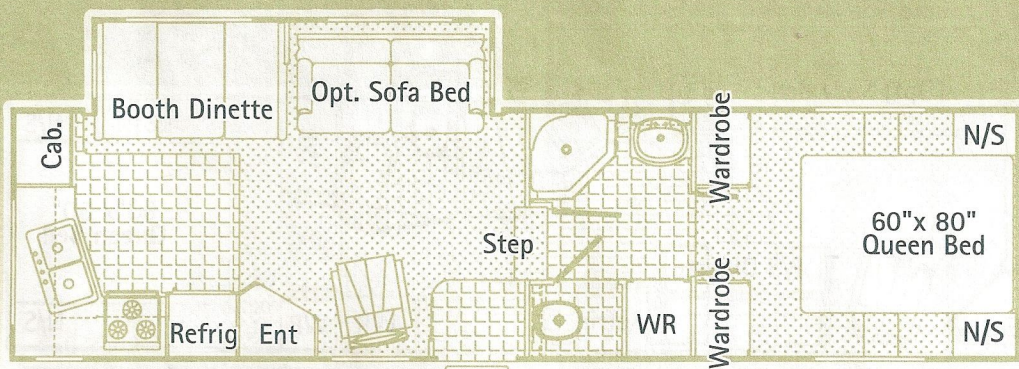

All specifications subject to change without notice or obligation 06/15/2001.

OVERALL LENGTH	LENGTH - PIN TO BUMPER	G.V.W.R.	PIN WEIGHT	DRY WEIGHT	OVERALL HEIGHT	MAIN BODY WIDTH
34' - 10"	29' - 3"	10,383 lb.	1,602 lb.	8,200 lb.	12' - 2"	96"

### CONSTRUCTION

**SIDEWALLS:** Vacuum bonded ultra smooth fiberglass siding, perimeter welded lightweight aluminum sidewall framing and 1 1/2" rigid foam insulation.

**ROOF:** Seamless polymer roof membrane is bonded to 3/8" plywood decking. Full 5 1/2" tapered aluminum truss framing. Thick fiberglass batt insulation. Cathedral ceiling in bedroom.

**FLOOR:** Composite laminated floor structure includes 3" foam insulation panel bonded between plywood panels and perimeter framing. Darco polyethylene moisture barrier between chassis and floor. Poly sheet panels are used to enclose the chassis underbelly. Seam guard under vinyl floor coverings.

**CHASSIS:** 11" combination Z channel/steel tube frame construction, twin 5,000 lb. 3" heavy duty axle assemblies, axle shocks at all wheels, Goodyear LT215/85R16" "E" radial tires, 6 bolt venting wheel rims, 12NZ, electric brakes, underslung spare tire and rim, snap release pins on powered front landing gear, 2 stabilizer scissor jacks, 72 degree adjustable pin box.

**SLIDE OUT SPECIFICATIONS:** Low maintenance powerful rack and gear direct drive motor system, flush floor design, gear box release lever included for system manual override.

**INTERIOR CABINET DOORS:** Raised panel oak cabinet doors. "Easy-Glide" metal roller system on all drawers.

**WINDOWS:** Radius corner, bronze tinted, solar reflective safety glass.

**ENTRANCE DOOR:** 30" wide radius corner combination entrance door with screen and deadbolt lock, easy fold-away 24" triple rise entry steps, fold away assist handle on entry door, porch light.

### APPLIANCES

**REFRIGERATOR:** Norcold 8 cu. ft. double door, 2 way gas/100V.

**RANGE:** Wedgewood H/O 21", 3 burner, piezo ignitor.

**FURNACE:** Atwood 2 stage Excalibur furnace 34,000 BTU ducted in floor heat system.

**MICROWAVE OVEN:** Dometic 22" 1.2 cu. ft. with turntable and built in range hood, light and exhaust fan.

**AIR CONDITIONER:** Dometic Briskair 13,500 BTU thermal insulated ducted in ceiling cool air system.

### ENTERTAINMENT

**STEREO:** Sanyo MCD-S500 AM/FM stereo CD with remote and clock.

**TV ANTENNA:** Winegard RV antenna with booster.

**TV HOOKUP:** Coax cable hookup in bedroom and living area.

**TELEPHONE JACK:** Standard equipment.

**SATELLITE HOOKUP:** Pre-wired for quick dish connection to the RV.

**EXTERIOR SOUND CENTRE:** 2 auxiliary speakers.

### AWNING

**A&E 19' AWNING:** Aloe/White awning features patented rugged steel roller tube and heavy duty torsion spring. 8' extension.

### PLUMBING

High profile Aqua magic foot pedal flush toilet, garden style corner shower, single lever faucet in kitchen and bath vanity, in-line water filter, water heater by-pass kit.

**WATER HEATER:** Atwood fast recovery 10 gallon gas/electric (Direct Spark Ignition).

**HOLDING TANKS:** Holding tanks are enclosed, insulated and heated. Garden style drain tap on fresh water tank, sewage tank flush system.

### HOLDING TANK CAPACITIES:

Fresh: 48 gallon Grey: 49 gallon Sewage: 49 gallon

**ELECTRICAL CONVERTOR:** Magnatek 7345 solid state circuitry, whisper quiet operation.

### OTHER STANDARD FEATURES

Fiberglass front and back end caps, roof rack and ladder, oak edge counter tops, daveno, exterior rinse shower, wire rack wardrobe shelf, venetian blinds, 2 x 30 lb. propane bottles with auto changeover reg. systems monitor panel, color co-ordinated ABS lower sidewall skirting, huge under bed storage cavity, french doors in bedroom area.

### OPTIONAL EQUIPMENT

Twin beds, oak free standing dinette in place of booth style dinette, sofa bed in place of daveno, electric fireplace insert, thermopane windows, generator ready connections, storm windows, Generac Impact 36LPG generator, day/night shades in place of venetian blinds, washer/dryer hookup, polished aluminum wheel package, dual exterior security lights, blanket box style sofa table, dual powered front landing gear, porcelain toilet.

### OPTIONAL FEATURE PACKAGE UPGRADES

**INTERIOR PACKAGE:** Fluorescent ceiling lights, day/night shades throughout in place of venetian blinds, oak galley area flooring in place of vinyl flooring.

**ENTERTAINMENT PACKAGE:** 27" Panasonic TV and stereo VCR.

**COMFORT PACKAGE:** 15,000 BTU air conditioner upgrade with digital programmable wall mount thermostat, powered roof vent in bedroom, central vacuum, living area paddle fan.

*Be sure to test tow this exciting  
fifth wheel today,  
"feel just how easy towing can be"*

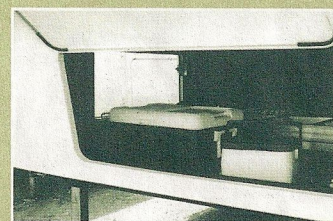

*Huge exterior storage compartments feature protective automotive style felt trunk lining.*

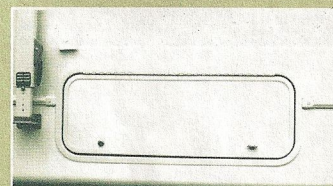

*All radius trunk door frame fasteners are located on the inside perimeter of the frame work and not exposed to RV exterior. This flush frame system looks great and makes cleaning the RV exterior much easier. Thumb style latch and centre key lock assembly make trunk access very easy.*



*"Solar reflective" bronze tinted windows provide greater privacy and improved thermal control.*

**Titanium**  
Glendale RV

# Titanium

## FIFTH WHEEL 29E34RL

2002  
MODEL YEAR

By Glendale RV  
Website: www.titaniumrv.com

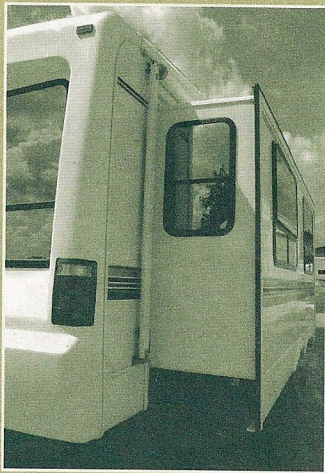

All power slide outs operate at the push of a button and shut down automatically when sealed flush. A combination of blade and automotive style bulb seals provide a weather tight barrier.

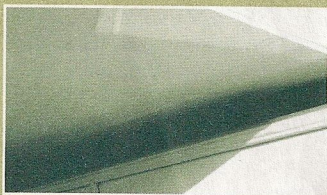

When closing the slide out, our combination rain sweep/bulb seal automatically wipes moisture and dust from the seamless aluminum slide out underbelly. This feature reduces carpet fatigue on the RV interior.

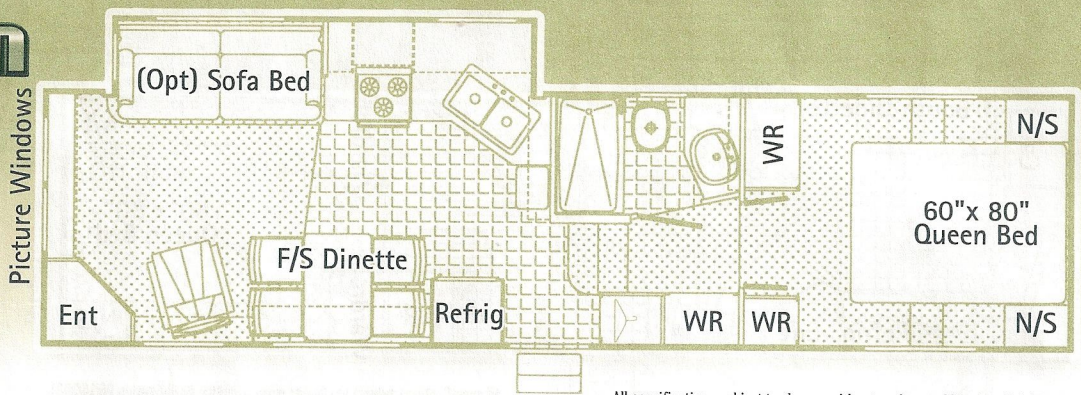

All specifications subject to change without notice or obligation 06/15/2001.

OVERALL LENGTH	LENGTH - PIN TO BUMPER	G.V.W.R.	PIN WEIGHT	DRY WEIGHT	OVERALL HEIGHT	MAIN BODY WIDTH
35' - 1"	29' - 11"	10,367 lb.	1,562 lb.	8,203 lb.	12' - 2"	96"

### CONSTRUCTION

**SIDEWALLS:** Vacuum bonded ultra smooth fiberglass siding. Perimeter welded lightweight aluminum sidewall framing and 1 1/2" rigid foam insulation.

**ROOF:** Seamless polymer roof membrane is bonded to 3/8" plywood decking. Full 5 1/2" tapered aluminum truss framing. Thick fiberglass batt insulation. Cathedral ceiling in bedroom.

**FLOOR:** Composite laminated floor structure includes 3" foam insulation panel bonded between plywood panels and perimeter framing. Darco polyethylene moisture barrier between chassis and floor. Poly sheet panels are used to enclose the chassis underbelly. Seam guard under vinyl floor coverings.

**CHASSIS:** 11" combination Z channel/steel tube frame construction, twin 5,000 lb. 3" heavy duty axle assemblies, axle shocks at all wheels, Goodyear LT215/85R16 "E" radial tires, 6 bolt venting wheel rims, 12NZ, electric brakes, underslung spare tire and rim, snap release pins on powered front landing gear, 2 stabilizer scissor jacks, 72 degree adjustable pin box.

**SLIDE OUT SPECIFICATIONS:** Low maintenance powerful rack and gear direct drive motor system, flush floor design, gear box release lever included for system manual override.

**INTERIOR CABINET DOORS:** Raised panel oak cabinet doors. "Easy-Glide" metal roller system on all drawers.

**WINDOWS:** Radius corner, bronze tinted, solar reflective safety glass.

**ENTRANCE DOOR:** 30" wide radius corner combination entrance door with screen and deadbolt lock, easy fold-away 24" triple rise entry steps, fold away assist handle on entry door, porch light.

### APPLIANCES

**REFRIGERATOR:** Norcold 8 cu. ft. double door, 2 way gas/110V.

**RANGE:** Wedgewood H/O 21", 3 burner, piezo ignitor.

**FURNACE:** Atwood 2 stage Excalibur furnace 34,000 BTU ducted in floor heat system.

**MICROWAVE OVEN:** Dometic 22" 1.2 cu. ft. with turntable and built in range hood, light and exhaust fan.

**AIR CONDITIONER:** Dometic Briskair 13,500 BTU thermal insulated ducted in ceiling cool air system.

### ENTERTAINMENT

**STEREO:** Sanyo MCD-S500 AM/FM stereo CD with remote and clock.

**TV ANTENNA:** Winegard RV antenna with booster.

**TV HOOKUP:** Coax cable hookup in bedroom and living area.

**TELEPHONE JACK:** Standard equipment.

**SATELLITE HOOKUP:** Pre-wired for quick dish connection to the RV.

**EXTERIOR SOUND CENTRE:** 2 auxiliary speakers.

### AWNING

**A&E 19'AWNING:** Aloe/White awning features patented rugged steel roller tube and heavy duty torsion spring. 8' extension.

### PLUMBING & ELECTRICAL

High profile Aqua magic foot pedal flush toilet, garden style corner shower, single lever faucet in kitchen and bath vanity, in-line water filter, water heater by-pass kit.

**WATER HEATER:** Atwood fast recovery 10 gallon gas/electric (Direct Spark Ignition).

**HOLDING TANKS:** Holding tanks are enclosed, insulated and heated. Garden style drain tap on fresh water tank, sewage tank flush system.

#### HOLDING TANK CAPACITIES:

Fresh: 48 gallon Grey: 49 gallon Sewage: 49 gallon

**ELECTRICAL CONVERTOR:** Magnatek 7345 solid state circuitry, whisper quiet operation.

### OTHER STANDARD FEATURES

Fiberglass front and back end caps, roof rack and ladder, oak edge counter tops, davenco, exterior rinse shower, wire rack wardrobe shelf, venetian blinds, 2 x 30 lb. propane bottles with auto changeover reg. systems monitor panel, color co-ordinated ABS lower sidewall skirting, huge under bed storage cavity, french doors in bedroom area.

### OPTIONAL EQUIPMENT

Twin beds, oak free standing dinette in place of booth style dinette, sofa bed in place of davenco, electric fireplace insert, generator aux connections, thermopane windows, storm windows, Generac Impact 36LPG generator, day/night shades in place of venetian blinds, dual exterior security lights, washer/dryer hookup, polished aluminum wheel package, blanket box style sofa table, dual powered front landing gear, porcelain toilet.

### OPTIONAL FEATURE PACKAGE UPGRADES

**INTERIOR PACKAGE:** Fluorescent ceiling lights, day/night shades throughout in place of venetian blinds, Oak galley area flooring in place of vinyl flooring.

**ENTERTAINMENT PACKAGE:** 27" Panasonic TV and stereo VCR.

**COMFORT PACKAGE:** 15,000 BTU air conditioner upgrade with digital programmable wall mount thermostat, powered roof vent in bedroom, central vacuum, living area paddle fan.

*Be sure to test tow this exciting  
fifth wheel today,  
"feel just how easy towing can be"*

**Go RVing**  
Life's A Trip™

**Titanium**  
Glendale RV

# Titanium

## FIFTH WHEEL 32E37

### 2002 MODEL YEAR

By Glendale RV  
Website: [www.titaniumrv.com](http://www.titaniumrv.com)

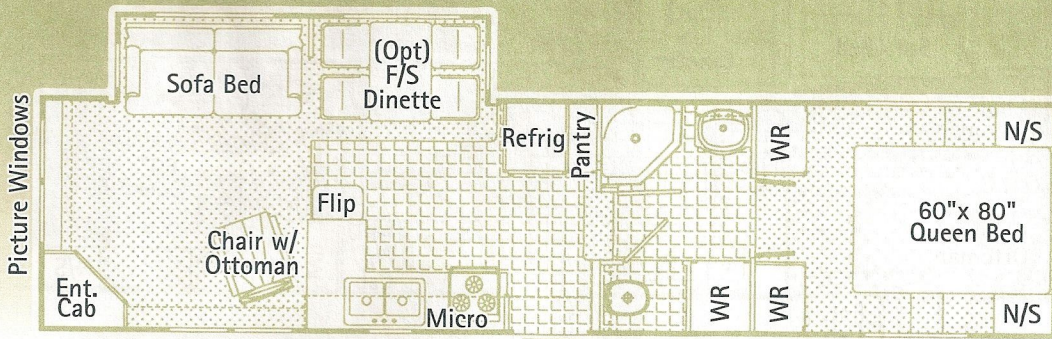

All specifications subject to change without notice or obligation 06/15/2001.

OVERALL LENGTH	LENGTH - PIN TO BUMPER	G.V.W.R.	PIN WEIGHT	DRY WEIGHT	OVERALL HEIGHT	MAIN BODY WIDTH
37' - 1"	31' - 11"	11,195 lb.	1,672 lb.	8,904 lb.	12' - 4"	96"

#### CONSTRUCTION

**SIDEWALLS:** Vacuum bonded ultra smooth fiberglass siding. Perimeter welded lightweight aluminum sidewall framing and 1 1/2" rigid foam insulation.

**ROOF:** Seamless polymer roof membrane is bonded to 3/8" plywood decking. Full 5 1/2" tapered aluminum truss framing. Thick fiberglass batt insulation. Cathedral ceilings in bedroom.

**FLOOR:** Composite laminated floor structure includes 3" foam insulation panel bonded between plywood panels and perimeter framing. Darco polyethylene moisture barrier between chassis and floor. Poly sheet panels are used to enclose the chassis underbelly. Seam guard under vinyl floor coverings.

**CHASSIS:** 11" combination Z channel/steel tube frame construction, twin 6,000 lb. 3" heavy duty axle assemblies, axle shocks at all wheels, Goodyear LT215/85R16" "E" radial tires, 6 bolt venting wheel rims, 12"x2" electric brakes, underslung spare tire and rim, snap release pins on powered front landing gear, 2 stabilizer scissor jacks, 72 degree adjustable pin box.

**SLIDE OUT SPECIFICATIONS:** Low maintenance powerful rack and gear direct drive motor system, flush floor design, gear box release lever included for system manual override.

**INTERIOR CABINET DOORS:** Raised panel oak cabinet doors. "Easy-Glide" metal roller system on all drawers.

**WINDOWS:** Radius corner, bronze tinted, solar reflective safety glass.

**ENTRANCE DOOR:** 30" wide radius corner combination entrance door with screen and deadbolt lock, easy fold-away 24" triple rise entry steps, fold away assist handle on entry door, porch light.

#### APPLIANCES

**REFRIGERATOR:** Norcold 8 cu. ft. double door, 2 way gas/110V.

**RANGE:** Wedgewood H/O 21", 3 burner, piezo ignitor.

**FURNACE:** Atwood 2 stage Excalibur furnace 40,000 BTU ducted in floor heat system.

**MICROWAVE OVEN:** Dometic 22" 1.2 cu..ft. I with turntable and built in range hood, light and exhaust fan.

**AIR CONDITIONER:** Dometic Briskair 13,500 BTU thermal insulated ducted in ceiling cool air system.

#### ENTERTAINMENT

**STEREO:** Sanyo MCD-S500 AM/FM stereo CD with remote and clock.

**TV ANTENNA:** Winegard RV antenna with booster.

**TV HOOKUP:** Coax cable hookup in bedroom and living area.

**TELEPHONE JACK:** Standard equipment.

**SATELLITE HOOKUP:** Pre-wired for quick dish connection to the RV.

**EXTERIOR SOUND CENTRE:** 2 auxiliary speakers.

#### AWNING

**A&E 21' AWNING:** Aloe/White awning features patented rugged steel roller tube and heavy duty torsion spring. 8' extension.

#### PLUMBING & ELECTRICAL

High profile *Aqua* magic foot pedal flush toilet, garden style corner shower, single lever faucet in kitchen and bath vanity, in-line water filter, water heater by-pass kit.

**WATER HEATER:** Atwood fast recovery 10 gallon gas/electric (Direct Spark Ignition).

**HOLDING TANKS:** Holding tanks are enclosed, insulated and heated. Garden style drain tap on fresh water tank, sewage tank flush system.

#### HOLDING TANK CAPACITIES:

Fresh: 48 gallon Grey: 49 gallon Sewage: 49 gallon

**ELECTRICAL CONVERTOR:** Magnatek 7346 solid state circuitry, whisper quiet operation.

#### OTHER STANDARD FEATURES

Fiberglass front and back end caps, roof rack and ladder, oak edge counter tops, sofa bed, exterior rinse shower, venetian blinds, 2x30 lb. propane bottles with auto changeover reg. systems monitor panel, molded ABS lower sidewall skirting, huge under bed storage cavity, french doors in bedroom area.

#### OPTIONAL EQUIPMENT

Optional rear window floor plan available, twin beds, oak free standing dinette in place of booth style dinette, electric fireplace insert, thermopane windows, generator ready connections, storm windows, Generac Impact 36LPG generator, day/night shades in place of venetian blinds, washer/dryer hookup, polished aluminum wheel package, colour coordinated lower sidewall skirting, dual exterior security lights, second occasional chair, dual front landing gear, porcelain toilet.

#### OPTIONAL FEATURE PACKAGE UPGRADES

**INTERIOR PACKAGE:** Fluorescent ceiling lights, day/night shades throughout in place of venetian blinds, oak galley area flooring in place of vinyl flooring.

**ENTERTAINMENT PACKAGE:** 27" Panasonic TV and stereo VCR.

**COMFORT PACKAGE:** 15,000 BTU air conditioner upgrade with digital programmable wall mount thermostat, powered roof vent in bedroom, central vacuum, living area, paddle fan.

#### Optional Floor Plan - Rear Entertainment Layout

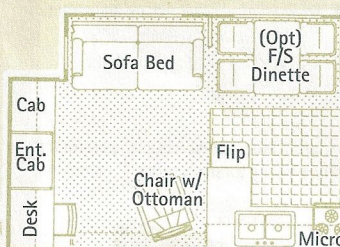

**Excalibur**  
2-Stage Furnace  
furnaces designed  
for quieter nights

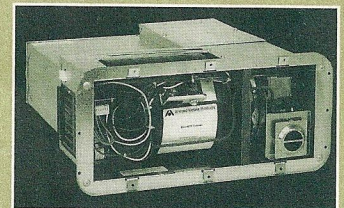

The 2-stage furnace with digital thermostat is designed to be energy efficient and includes significantly less operating noise for quieter nights!

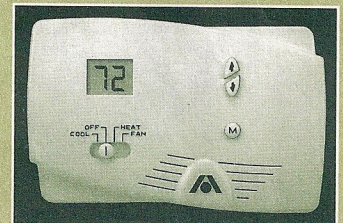

#### Unique 2-stage System

Set the temperature, turn the thermostat on "automatic" and let the furnace take over! During cold start-ups, the furnace operates on high burn, high fan for quick, quiet warm up. Then, when the temperature is reached, the furnace automatically switches to low burn, low fan to maintain the comfortable environment you want. It's quiet, efficient, and you conserve energy.

Titanium  
Glendale RV

# Titanium

## FIFTH WHEEL 32E37DS

2002  
MODEL YEAR

By Glendale RV  
Website: www.titaniumrv.com



Magnetek powers you into the future with its 7400 series electronic convertor. Whisper quiet operation delivers ultra-clean D.C. power without "surges and spikes", no matter how unstable the A.C. source. Clean power minimizes signal interference with TV's, radios and emergency channels.



"Large Capacity"  
**10**  
gallon (D.S.I.)  
Water Heater

Your new Titanium Fifth Wheel water heater offers the convenience of fast recovery and provides hassle free operation with direct spark ignition. The water heater operates on either LPG or 110V source.

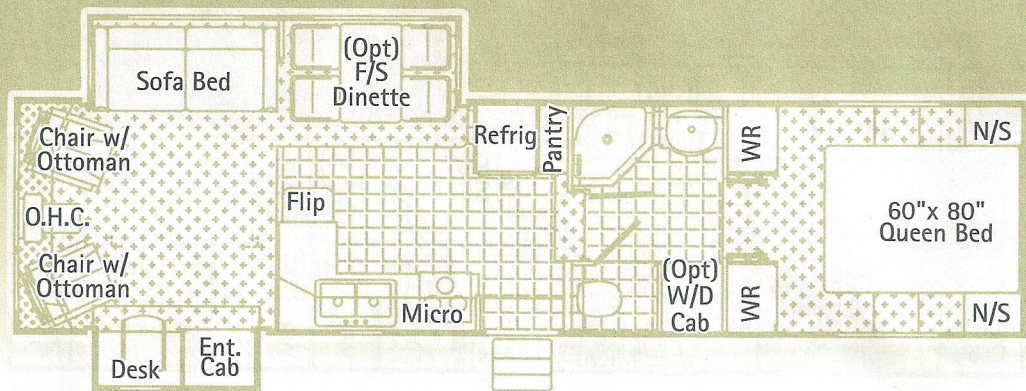

All specifications subject to change without notice or obligation 06/15/2001.

OVERALL LENGTH	LENGTH - PIN TO BUMPER	G.V.W.R.	PIN WEIGHT	DRY WEIGHT	OVERALL HEIGHT	MAIN BODY WIDTH
37' - 1"	31' - 11"	11,463 lb.	1,720 lb.	9,118 lb.	12' - 4"	96"

### CONSTRUCTION

**SIDEWALLS:** Vacuum bonded ultra smooth fiberglass siding, perimeter welded lightweight aluminum sidewall framing and 1 1/2" rigid foam insulation.

**ROOF:** Seamless polymer roof membrane is bonded to 3/8" plywood decking. Full 5 1/2" tapered aluminum truss framing. Thick fiberglass batt insulation. Cathedral ceilings in bedroom.

**FLOOR:** Composite laminated floor structure includes 3" foam insulation panel bonded between plywood panels and perimeter framing. Darco polyethylene moisture barrier between chassis and floor. Poly sheet panels are used to enclose the chassis underbelly. Seam guard under vinyl floor coverings.

**CHASSIS:** 11" combination Z channel/steel tube frame construction, twin 6,000 lb. 3" heavy duty axle assemblies, axle shocks at all wheels, Goodyear LT215/85R16 "E" radial tires, 6 bolt venting wheel rims, 12"x2" electric brakes, underslung spare tire and rim, snap release pins on powered front landing gear, 2 stabilizer scissor jacks, 72 degree adjustable pin box.

**SLIDE OUT SPECIFICATIONS:** Low maintenance powerful rack and gear direct drive motor system, flush floor design, gear box release lever included for system manual override.

**INTERIOR CABINET DOORS:** Raised panel oak cabinet doors. "Easy-Glide" metal roller system on all drawers.

**WINDOWS:** Radius corner, bronze tinted, solar reflective safety glass.

**ENTRANCE DOOR:** 30" wide radius corner combination entrance door. with screen and deadbolt lock, easy fold-away 24" triple rise entry steps, fold away assist handle on entry door, porch light.

### APPLIANCES

**REFRIGERATOR:** Norcold 8 cu. ft. double door, 2 way gas/110V.

**RANGE:** Wedgewood H/O 21", 3 burner, piezo ignitor.

**FURNACE:** Atwood 2 stage Excalibur furnace 40,000 BTU ducted in floor heat system.

**MICROWAVE OVEN:** Dometic 22" 1.2 cu. ft. with turntable and built in range hood, light and exhaust fan.

**AIR CONDITIONER:** Dometic Briskair 13,500 BTU thermal insulated ducted in ceiling cool air system.

### ENTERTAINMENT

**STEREO:** Sanyo MCD-S500 AM/FM stereo CD with remote and clock.

**TV ANTENNA:** Winegard RV antenna with booster.

**TV HOOKUP:** Coax cable hookup in bedroom and living area.

**TELEPHONE JACK:** Standard equipment.

**SATELLITE HOOKUP:** Pre-wired for quick dish connection to the RV.

**EXTERIOR SOUND CENTRE:** 2 auxiliary speakers.

### AWNING

**A&E 21' AWNING:** Aloe/White awning features patented rugged steel roller tube and heavy duty torsion spring. 8' extension.

### PLUMBING & ELECTRICAL

High profile Aqua magic foot pedal flush toilet, garden style corner shower, single lever faucet in kitchen and bath vanity, in-line water filter, water heater by-pass kit.

**WATER HEATER:** Atwood fast recovery 10 gallon gas/electric (Direct Spark Ignition).

**HOLDING TANKS:** Holding tanks are enclosed, insulated and heated. Garden style drain tap on fresh water tank, sewage tank flush system.

### HOLDING TANK CAPACITIES:

Fresh: 48 gallon Grey: 49 gallon Sewage: 49 gallon

**ELECTRICAL CONVERTOR:** Magnatek 7345 solid state circuitry, whisper quiet operation.

### OTHER STANDARD FEATURES

Fiberglass front and back end caps, roof rack and ladder, oak edge counter tops, sofa bed, exterior rinse shower, venetian blinds, 2 x 30 lb. propane bottles with auto changeover reg., systems monitor panel, huge under bed storage cavity, french doors in bedroom area, chairs with ottoman.

### OPTIONAL EQUIPMENT

Oak free standing dinette in place of booth style dinette, electric fireplace insert, thermopane windows, generator ready connections, storm windows, Generac Impact 36LPG generator, day/night shades in place of venetian blinds, washer/dryer hookup, polished aluminum wheel package, colour coordinated lower sidewall skirting, dual exterior security lights, dual front landing gear, porcelain toilet.

### OPTIONAL FEATURE PACKAGE UPGRADES

**INTERIOR PACKAGE:** Fluorescent ceiling lights, day/night shades throughout in place of venetian blinds, oak galley area flooring in place of vinyl flooring.

**ENTERTAINMENT PACKAGE:** 27" Panasonic TV and stereo VCR.

**COMFORT PACKAGE:** 15,000 BTU air conditioner upgrade with digital programmable wall mount thermostat, powered roof vent in bedroom, central vacuum, living area paddle fan.

### Optional Floor Plan - Rear Desk/Entertainment Layout

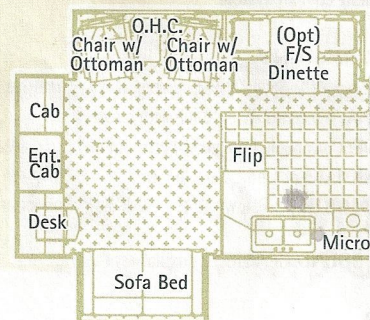

Titanium  
Glendale RV