

Titanium 25E30 Mid Kitchen

 [Print Model Information](#)

▶ IMAGE GALLERY

Exterior Image



Interior Images

Shown here in our New 2008 Cinnamon Decor Scheme.



"Kitchen & Entryway"



"Optional 26" HD LCD TV available with the 25E30.



"Bedroom & Bath Area"



virtual tour

Main area virtual.....

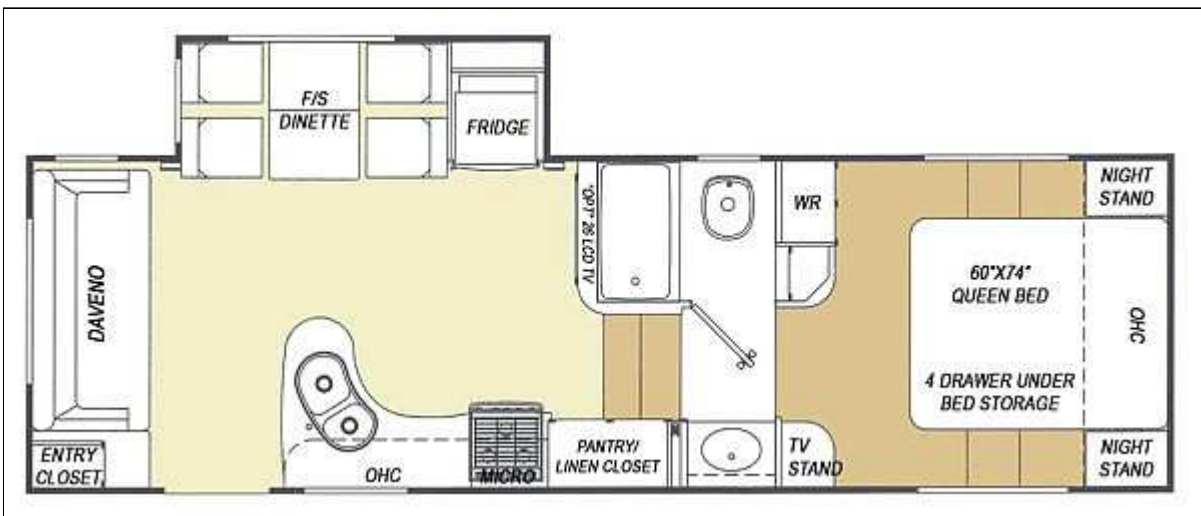

virtual tour

"Twin Bed Option Layout"

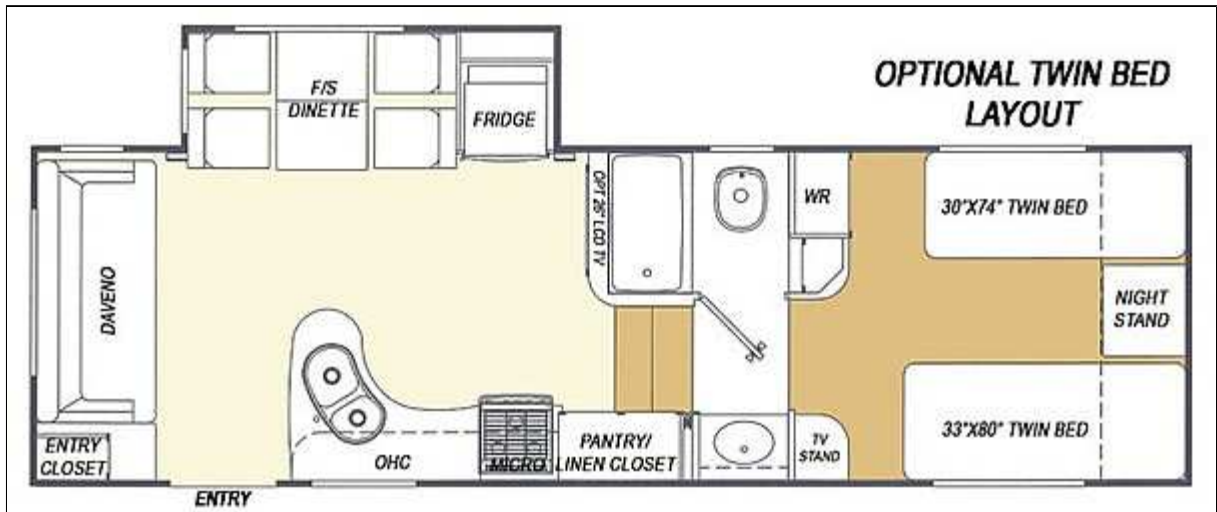

► Floor Plan

▲ [TOP](#)

► Specifications

DIMENSIONS

SLEEPS	4
OVERALL LENGTH	30' - 5"
LENGTH-PIN TO BUMPER	25' - 3"
OVERALL HEIGHT	12' - 5"
DRY PIN WEIGHT	1,429 lbs.
DRY WEIGHT	7,853 lbs.
G.V.W.R.	9,968 lbs.
MAIN BODY WIDTH	96"
MAX. LIVING AREA HEIGHT	100"
MAX. BEDROOM HEIGHT	77"

CONSTRUCTION

Sidewalls	Vacuum bonded smooth fiberglass siding. 1-1/2" light weight Aluminum Perimeter sidewall framing, and 1-1/2" rigid foam insulation. R9 Insulation.
Roof	Seamless rubber roof membrane is bonded to 3/8" plywood decking. Full 4-1/2" tapered metal truss framing. Thick fiberglass batt insulation. Cathedral ceilings in the bedroom. R14 Insulation.
Floor	Laminated composite floor structure includes 3" foam insulation panel bonded between plywood panels and perimeter framing. Darco polythene moisture barrier between chassis underbelly. Seam guard under vinyl floor coverings. R16 insulation.

11" combination Z channel/steel tube frame construction, Goodyear ST235/80R16D radial tires,

Chassis	venting wheel rims 12"x2" electric brakes, underslung spare tire and rim, snap release pins on powered front landing gear, power landing gear includes a safety shut off switch, 2 stabilizer jacks, 72 degree adjustable pin box.
Slideout	Low maintenance powerful rack and gear 12V direct drive motor system, flush floor design, manual system override.
Interior	Cabinet doors combination of Raised panel & arch style beech color cabinet doors. Easy-Glide metal roller system on all drawers.
Entrance Door	30" wide radius corner combination entrance door with screen and deadbolt lock, easy fold-away 24" triple rise entry steps, fold away assist handle on entry door, porch light.

PLUMBING & ELECTRICAL

Sealand Traveler Lite foot pedal flush china toilet with hand spray Large tub and surround, single lever brushed brass faucet in kitchen with sprayer, all in one solid surface counter with deep double sinks, brushed brass single lever tap in bathroom, water heater by pass kit, Water Filtration System.

Water Heater	Atwood XT H2OT Advanced 10 Gallon gas/electric (Direct Spark Ignition) featuring Exothermal Technology which provides the equivalence of 16 Gallons of hot water.
Electrical	Progressive Dynamics 9200A series converter w/charge wizard.
Hookup	30 AMP
Holding Tanks	Holding tanks are enclosed, insulated and heated. Garden Style non-freeze drain tap on fresh water tank, sewage tank flush system.

HOLDING TANK CAPACITIES

Fresh	63 gallon
Grey	49 gallon
Sewage	49 gallon

[▲ TOP](#)

Standard Features & Popular Options

STANDARD FEATURES

- Free standing dinette,
- Daveno
- 60"x74" Queen Bed
- DVD / CD 5.1 Surround Sound System
- Atwood XT Water Heater
- Never Lube Axle Hubs
- 400 watt power inverter
- All in one Solid Surface kitchen
Countertop with deep double kitchen sinks
- Porcelain toilet,
- Day/Night Shades,
- Bathroom Skylight above shower area
- Excalibur whisper quiet 2 stage furnace
- 13,500 BTU ducted Air Conditioning
- A&E 13' Awning
- Attic vents
- Barbeque quick connect
- Base board and ceiling trim crown molding
- Bullet style directional reading lights
- Wedgewood High Output 21"
- Range 3 burner, piezo ignitor
- 12v power boosted TV Antenna
- Phone jack
- Park cable hookup
- Satellite hookup
- Stabilizer Jacks
- Black Tank Flush system
- Exterior Shower, Spare tire & Rim
- 12V Flashlight
- Fold-away entry assist handle
- Wide track easy fold triple entry steps
- Cartridge style water filter system
- Single lever kitchen faucet with hand held rinse attachment
- Dual powered landing gear

POPULAR OPTIONS

- Thermopane windows
- Aluminum rims
- Exterior security lights
- 10 cu ft fridge
- Plank flooring in kitchen area
- Dual exterior security lights
- Fluorescent lighting
- Electric fireplace
- MorRyde Pin box
- Basic rough-in service for Generator prep (LP/Electrical lines only)
- Generator Prep (Box&Venting)
- Video command center
- 9 cubic ft fridge
- 26" LCD TV
- 20" LCD TV in bedroom
- Rear Electric Stabilizer Jacks
- 6,000 lbs axle upgrade
- High Gloss Exterior walls
- 30" Microwave oven with built-in range hood light and exhaust fan

COMFORT PACK OPTION

15,000 BTU Air Conditioner with quick cool down draft diverter, trickle solar charger, Hepa filter and digital wall mount dual control thermostat, 12V powered roof vent in bedroom includes rain sensor, Central vacuum and attachments

 [TOP](#)

All specifications subject to change without notice or obligation.

Copyright © 2006 Glendale Recreational Vehicles